

AUTOPLUS 36



CE EN60974-7

CODIGO	↔	⏏	⏏
--------	---	---	---

MA0574	3 m	10'	45°	 EURO
MA0577	3 m	10'	0°	

DATOS TECNICOS	
----------------	--

	0,9 kg 1.98 lb
V PEAK	113
	0,8 ÷ 1,6 mm .030" ÷ 1/16"
X 60%	340A CO ₂ - 320A Mix

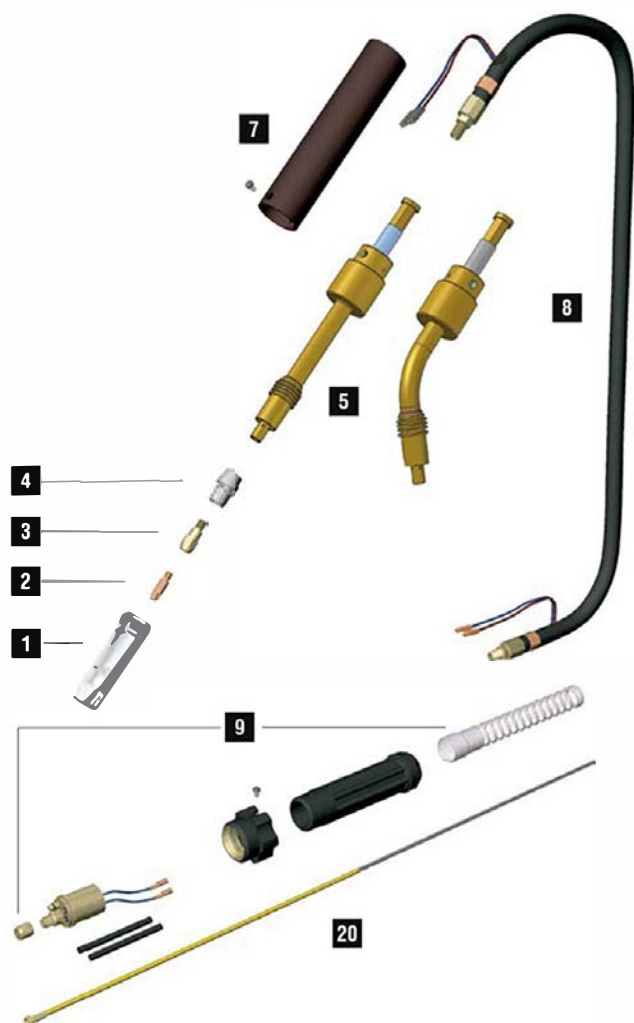
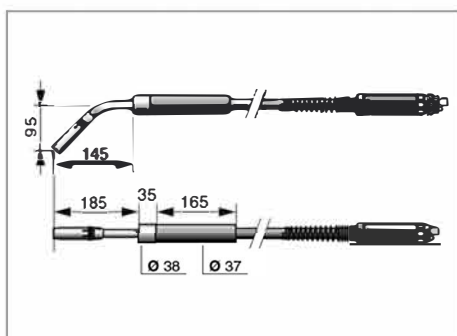

www.asistesol.com

	CODIGO			Ø		↔	REF		
1	MC0026		2,5 mm	12 mm	1/2"	84 mm	145.0126	10	
1	MC0027		2,5 mm	16 mm	5/8"	84 mm	145.0078	10	
1	MC0028		2,5 mm	19 mm	3/4"	84 mm	145.0045	10	
1	MC0109		2,5 mm	17 mm		84 mm	-	10	
1	MC0110		2,5 mm	20 mm		90 mm	145.0172	10	
1	MC0440		light 2 mm	16 mm	5/8"	84 mm		10	
1	MC0527		quick release 2,5 mm	16 mm	5/8"	84 mm	-	10	
1	MC0540		quick release - light 2 mm	16 mm	5/8"	84 mm	-	10	
2	MD0009-76		M6 - CuCrZr	0,6 mm	.023"	28 mm	-	20	
2	MD0009-78		M6 - CuCrZr	0,8 mm	.030"	28 mm	140.0054	20	
2	MD0009-80		M6 - CuCrZr	1,0 mm	.040"	28 mm	140.0245	20	
2	MD0009-82		M6 - CuCrZr	1,2 mm	.045"	28 mm	140.0382	20	
2	MD0009-84		M6 - CuCrZr	1,4 mm	.052"	28 mm	-	20	
2	MD0009-86		M6 - CuCrZr	1,6 mm	1/16"	28 mm	-	20	
3	MD0063-00		M6 - brass			28 mm	142.0005	20	
3	MD0131-00		M6 - brass			32 mm	142.0011	20	
4	ME0017		plastic			32,8 mm	014.0261	10	
4	ME0041		plastic			32,8 mm	014.0021	10	
4	ME0417		plastic compound high tech			32,8 mm	-	10	
4	ME0517		ceramic			32,8 mm	014.0023	10	
20	GM0540		yellow steel liner	1,2 ÷ 1,6 mm	.045" ÷ 1/16"	3 m	10'	124.0041	1

	CODIGO								
5	MF0077		mig torch head 45°	1	9	AR0070		EURO connection	1
5	MF0078		mig torch head 0°	1	9	BW0020		Euro nut metal	
7	MP0125		handle		9	FA0026		liner nut M10X1	
8	MH0120		3 m - 10' - 50 mm²		9	MT0229		Back box kit euro	1



FOR ALL CONSUMABLES SEE PAGE 294

www.asistesol.com