

AUTOPLUS 600 WIRE CONDUIT+GAS



CODIGO				
--------	--	--	--	--

MB0583	3 m	10'	45°	 EURO
MB0593	3 m	10'	0°	

DATOS TECNICOS	
----------------	--

	1,6 kg	3,53 lb
V PEAK	113	
	1,0 ÷ 2,4 mm	.040" ÷ 3/32"
X 100%	600A CO2 - 550A Mix	
	2÷4 bar	
	1,6 l/min	

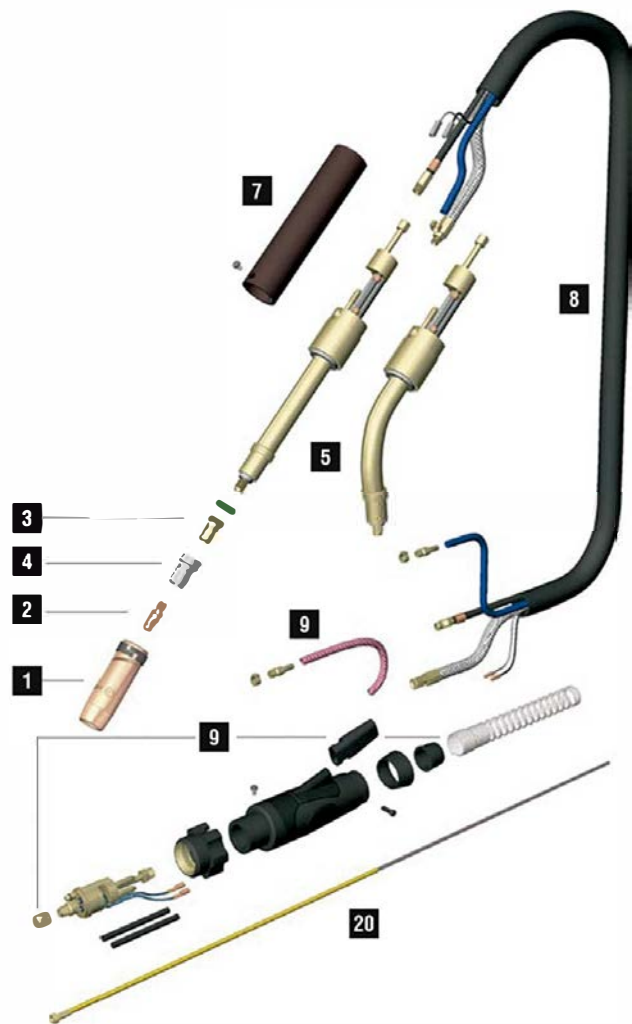
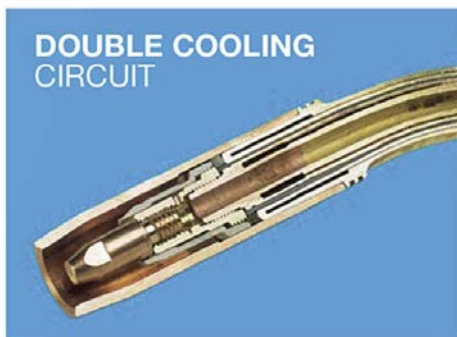
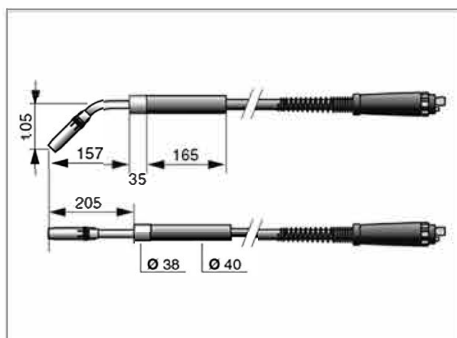

	CODIGO			Ø		↔	REF		
1	MC0268		2,5 mm	16 mm	5/8"	76 mm	145.0085	10	
1	MC0276		light 2 mm	16 mm	5/8"	76 mm	145.0085	10	
1	MC0290		2,5 mm	14 mm		76 mm	145.0132	10	
1	MC0291		2,5 mm	20 mm		76 mm	145.0051	10	
1	MC0292		2,5 mm	15 mm		76 mm	-	10	
1	MC0293		2,5 mm	20 mm		82 mm	145.0179	10	
1	MC0340		heavy duty 3 mm	16 mm	5/8"	76 mm	Heavy duty	10	
1	MC0568		quick release 2,5 mm	16 mm	5/8"	76 mm	-	10	
1	MC0576		quick release - light 2 mm	16 mm	5/8"	76 mm	-	10	
2	MD0005-80		M8 - CuCrZr	1,0 mm	.040"	30 mm	140.0316	20	
2	MD0005-82		M8 - CuCrZr	1,2 mm	.045"	30 mm	140.0445	20	
2	MD0005-84		M8 - CuCrZr	1,4 mm	.052"	30 mm	-	20	
2	MD0005-86		M8 - CuCrZr	1,6 mm	1/16"	30 mm	140.0590	20	
3	ME0076		M8 - brass			25 mm	-	10	
3	ME0083		M8 - brass			29 mm	-	10	
3	ME0390		M8 - copper			25 mm	-	10	
4	ME0074		plastic			28 mm	-	10	
4	ME0079		plastic			29 mm	300029	10	
4	ME0479		plastic High Tec			28 mm	-	10	
4	ME0579		ceramic	16 mm	5/8"	28 mm	-	10	
20	GM0540		yellow steel liner	1,2 ÷ 1,6 mm	.045" ÷ 1/16"	3 m	10'	124.0041	1

	CODIGO		
5	FB1327		10
5	MG0066		1
5	MG0067		1
7	MP0126		
9	AR0102		
9	BW0020		
9	FA0026		10
9	MT0101		1

	CODIGO	CABLE	
8	MN0022	3 m / 10' - 16 mm ²	

	CODE	↔	CODIGO	↔
8a	BX0156	3 m / 10'	8f	MQ0205
8d	QB0076	3 m / 10'	8g	QB0090
8e	QA0019	3 m / 10'		

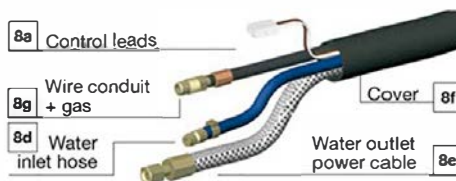

STANDARD

FOR ALL CONSUMABLES SEE PAGE 294

www.asistesol.com